

Self-guided Tour

This 3.3-mile outer loop trail will take you through a mosaic of native habitats beginning with scrubby flatwoods at **Trail Marker #1**, to oak hammocks and pine flatwoods with a scattering of sloughs and seasonal marshes. On the way, make sure and look for gopher tortoise burrows, Florida scrub-jays, wading birds, bromeliads and other wild flowers.

Some points of particular interest are:

Trail Marker

#2 Take the river trail and pass beneath a dense oak canopy festooned with air plants (bromeliads). This trail ends with a spectacular view of the Myakka River.

#2-3 Notice more bromeliads on your left in the oak hammock.

#4 The side trail to the left yields a surprise overlook of the river. Along this trail notice the patches of red blanket lichen on the tree trunks.

#4-6 The trail offers a shady walk through the oak hammock.

#6 The side trail to the river is just a short walk through the pine flatwoods extending right up to the river bank.

#8 Walk along the edge of a seasonal marsh and look for various species of wading birds and colorful purple iris blooms in early spring.

#10 The large open grassy area to the east is a former pasture used for cattle grazing.

#11-12 The large seasonal marsh south of the trail is filled with water and is visited by wading birds during the rainy season.

#12-19 Enjoy the return walk through the various habitats. Be sure to watch for a variety of plants and wildlife!

Our thanks to
**The Nature Conservancy's
Natural Heritage Fund**
for Sarasota County
for assistance in providing public use
amenities at this preserve.
You may contact



at 941-366-3130

The Jelks Preserve
2300 North River Road, Venice, FL
(between Venice Avenue and Center Road)
For more information
call the Sarasota County Call Center
at 941-861-5000.



Sarasota County
scgov.net | 941.861.5000 | TV19

Welcome to,

The Jelks Preserve

Open Daily
7:30 AM – 8 PM (April – October)
7:30 AM – 6 PM (November – March)

PLEASE REMEMBER:

- Hiking trails are limited to foot traffic only.
- THERE ARE NO RESTROOMS OR DRINKING WATER ON THE PRESERVE so please plan accordingly.
- 'If you pack it in, pack it out.'

GPS Coordinates for Trail Head:
LAT: 27° 05.492'
LONG: 82° 20.265'

The Jelks Preserve

Legend

- Property Boundary
- Paved Road
- Loop Trail (3.3 Miles)
- Secondary Trail
- Picnic Area
- Distance (miles)
- Bench

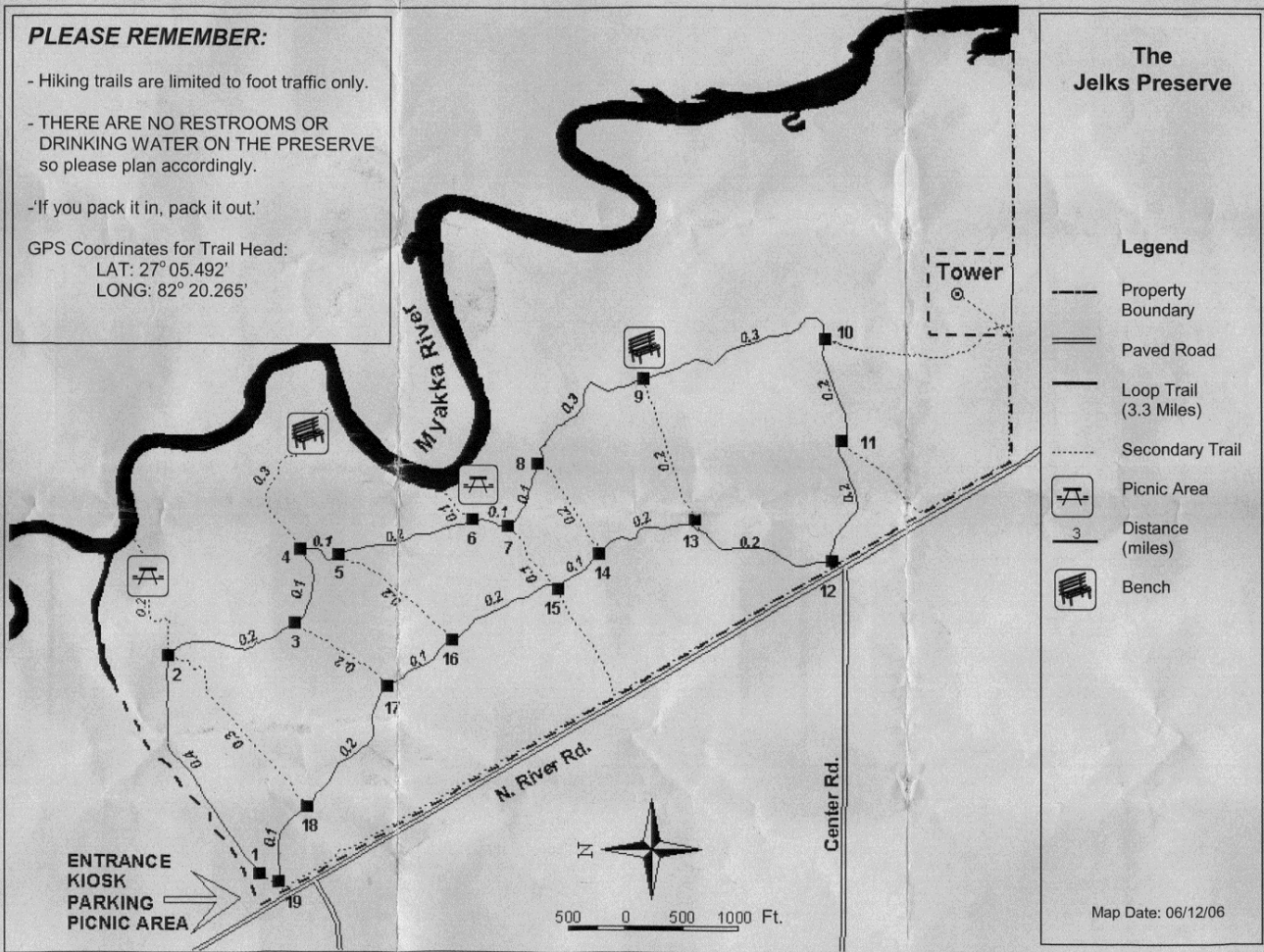

ENTRANCE
KIOSK
PARKING
PICNIC AREA

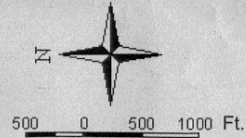

Map Date: 06/12/06